



**MADE IN
GREEN**

Standard

OEKO-TEX® MADE IN GREEN

Edition 01.2025

OEKO-TEX®

International Association for Research and Testing in
the Field of Textile and Leather Ecology

OEKO-TEX Service GmbH
Genferstrasse 23, CH-8002 Zurich
+41 44 501 26 00
www.oeko-tex.com



MADE IN GREEN

Contents

1. Purpose.....	3
2. OEKO-TEX® MADE IN GREEN applicability.....	3
2.1 Requirements and criteria: B2C (finished products that consumers can buy at retailers)	4
2.2 Requirements and criteria: B2B (semi-finished products sold to companies within the supply chain).....	5
3. OEKO-TEX® MADE IN GREEN trademark.....	5
3.1 Content and statement.....	5
3.2 Licensing (trademark).....	7
3.3 Trademark use.....	8
4. Procedure for obtaining the OEKO-TEX® MADE IN GREEN label	8
4.1 General conditions	8
4.2 The myOEKO-TEX® platform	8
4.3 The MADE IN GREEN Process	9
4.3.1 Application	9
4.3.2 Connection	9
4.3.3 Article definition.....	10
4.3.4 Label preparation	14
4.3.5 Labelling.....	14
5. Basis of legal relationship	14
5.1 Basis of OEKO-TEX® MADE IN GREEN	14
5.2 Use of the trademark OEKO-TEX® MADE IN GREEN	14
5.3 OEKO-TEX® Quality Assurance.....	15
5.4 Usage of the MADE IN GREEN label.....	15
5.4.1 Validity	15
5.4.2 Misuse and Withdrawal of license.....	15
Annex 1.....	16



MADE IN GREEN

Annex 2	16
Annex 3	16
3.1 Use of the MADE IN GREEN label by third parties	16
3.2 Relabelling of an existing product ID by a third party	17
3.3 Use of the MADE IN GREEN advertisement label by third parties	17
Annex 4	17
4.1 Examples of the implementation of the MADE IN GREEN criteria	17
Annex 5	18
5.1 Additional Terms	18
5.2 Types of Operation	18
5.3 Type of Dashboard Users	18
I Annex.....	19
II Annex.....	19

Impressum

Media owner and publisher
OEKO-TEX Service GmbH Genferstrasse 23
CH-8002 Zurich

Place of origin
Zurich (Switzerland)

Printing
Own copy system



1. Purpose

The MADE IN GREEN Standard belongs to the testing, certification and licensing (OEKO-TEX® products) offered by the International Association for Research and Testing in the Field of Textile and Leather Ecology, represented by OEKO-TEX Service GmbH (OEKO-TEX®). Further information on the product portfolio and a list of the institutes approved by OEKO-TEX® (Institute) according to Annex 1 OEKO-TEX® Institutes can be found on the OEKO-TEX® website (www.oeko-tex.com).

The MADE IN GREEN Standard is a normative document in which the conditions for obtaining the OEKO-TEX® MADE IN GREEN label (MADE IN GREEN) are specified. The applicable Terms of Use (ToU) for all OEKO-TEX® products (standards) as defined in Annex II also apply.

The objective of MADE IN GREEN is to provide product traceability. According to the OEKO-TEX® guidelines, these products should be tested for harmful substances and produced in a sustainable manner, i.e. in an environmentally friendly and socially responsible manner. This requires the transparency of all textile and leather production processes within a supply chain. In addition, the production facilities or materials used in production must be certified by OEKO-TEX®. The certification for textiles is OEKO-TEX® STANDARD 100 or OEKO-TEX® ORGANIC COTTON (STANDARD 100, OEKO-TEX® ORGANIC COTTON). The certification for leather is OEKO-TEX® LEATHER STANDARD (LEATHER STANDARD). The certification for textile and leather production facilities is OEKO-TEX® STeP (STeP).

By making the supply chains transparent, MADE IN GREEN promotes transparency and creates a means of communication to provide consumers and other stakeholder groups with credible information about responsible action.

This document is regularly updated. Its current version can be found at www.oeko-tex.com.

2. OEKO-TEX® MADE IN GREEN applicability

Every qualifying company within the textile and leather supply chain can label its products and product lines with the MADE IN GREEN label. This applies not only to manufacturers, but also to converters, wholesalers, retailers and brands. The latter can issue a MADE IN GREEN label with their own product ID¹ without being certified according to STeP, provided they do not manufacture the said product themselves (in wet or chemical processes and in the making up of products) and their suppliers fulfil the MADE IN GREEN requirements and criteria.

Service providers (e.g. commission dyers) cannot issue MADE IN GREEN Product IDs.

¹ Each issued MADE IN GREEN label has an individual product ID. The product ID is also the license number for using the MADE IN GREEN label. The product ID, which is available as a verification number and/or QR code, shows that the product has been tested for harmful substances and sustainably produced and even where it was manufactured. This information can be obtained by entering the product number in the label check on www.oeko-tex.com or by scanning the QR code.



MADE IN GREEN

2.1 Requirements and criteria: B2C (finished products that consumers can buy at retailers)



Criteria 1:

The product shall be certified according to OEKO-TEX® STANDARD 100, ORGANIC COTTON or LEATHER STANDARD.

Criteria 2:

All the making up facilities shall be OEKO-TEX® STeP certified.

Criteria 3:

Single components that equal or exceed 5% of the total weight of the product shall be supplied by OEKO-TEX® STeP certified production facilities. This concerns only facilities with wet/chemical processes. Metal and plastic accessories, as well as rubber and cardboard are not considered.

Criteria 4:

The main objective of an OEKO-TEX® MADE IN GREEN label is to provide product traceability through each production step. Each MADE IN GREEN label supply chain should be a linear sequence of operations (production steps) representing the whole product-specific manufacturing process. For each MADE IN GREEN product ID, the corresponding supply chain should be defined in the MADE IN GREEN dashboard without branches or alternatives*. The production processes for all main components that fulfil criteria 2 and 3 shall be included in the supply chain. For finished products, the making up facility, plus at least three components shall be defined and confirmed. Each company in the MADE IN GREEN label supply chain shall be registered in the myOEKO-TEX® platform and using the MADE IN GREEN dashboard.

*

- Only one making up facility per label supply chain is allowed unless there is another making up process specific to that product (double sourcing requires separate product IDs).
- Only one wet/chemical facility per label supply chain is allowed unless there is another wet/chemical process specific to that product (double sourcing requires separate product IDs).



- Multiple raw materials, yarns, accessories, and chemical suppliers per MADE IN GREEN label supply chain are allowed.

2.2 Requirements and criteria: B2B (semi-finished products sold to companies within the supply chain)

Criteria 1:

The product shall be certified according to OEKO-TEX® STANDARD 100, ORGANIC COTTON or LEATHER STANDARD.

Criteria 2:

Any making up facilities shall be OEKO-TEX® STeP certified.

Criteria 3:

Single components that equal or exceed 5% of the total weight of the product shall be supplied by OEKO-TEX® STeP certified production facilities. This concerns only facilities with wet/chemical processes. Metal and plastic accessories, as well as rubber and cardboard, are not considered.

Criteria 4:

The main objective of an OEKO-TEX® MADE IN GREEN label is to provide product traceability through each production step. Each MADE IN GREEN label supply chain should be a linear sequence of operations (production steps) representing the whole product-specific manufacturing process. For each MADE IN GREEN product ID, the corresponding label supply chain should be defined in the MADE IN GREEN dashboard without branches or alternatives*. The production processes for all main components that fulfil criteria 2 and 3 shall be included in the supply chain. For semi-finished products, at least one component from a supplier shall be defined and confirmed. Each company in the MADE IN GREEN label supply chain shall be registered in the myOEKO-TEX® platform and using the MADE IN GREEN dashboard.

*

- Only one making up facility per label supply chain is allowed unless there is another making up process specific to that product (double sourcing requires separate product IDs).
- Only one wet/chemical facility per label supply chain is allowed unless there is another wet/chemical process specific to that product (double sourcing requires separate product IDs).
- Multiple raw materials, yarns, accessories and chemical suppliers per MADE IN GREEN label supply chain are allowed.

Criteria 5: for B2B only

The MADE IN GREEN label owner shall be certified according to OEKO-TEX® STeP. Traders and converters are excluded, but the semi-finished product that they are going to sell must come from a STeP certified company.

3. OEKO-TEX® MADE IN GREEN trademark

3.1 Content and statement

The OEKO-TEX® MADE IN GREEN trademark provides a supply chain traceable product label for all kinds of:

- textiles (e.g. garments, home textiles, fabrics, nonwovens, textile accessories),
- leathers (e.g. garments, finished and semi-finished leathers, leather fibre boards, leather accessories)



The MADE IN GREEN label assures the user that the textile or leather product:

- is from materials tested for harmful substances,
- was produced in environmentally friendly facilities and
- safe and socially responsible workplaces.

MADE IN GREEN offers transparency through the ability to identify, compare and evaluate supply chains. It can thus be shown where the different stages of product manufacturing have taken place. Each article awarded with the MADE IN GREEN label can be transparently traced by means of a unique product ID or QR code. The label provides information about the production facilities along the supply chain where the textile or leather was produced, which production stage the participating companies belong to and in which countries the production took place. This transparency allows partners in the B2B business to evaluate the supply chain.

The MADE IN GREEN label serves as a special means of communication for companies that present their responsible processes and supports consumers (B2C) in making sustainable purchasing decisions by providing information that is quickly accessible.

The MADE IN GREEN label stands both for a commitment to sustainable textile or leather production and for continuous investment in quality and safety in conjunction with sustainability along the supply chain.

A MADE IN GREEN product ID proves that all textile, leather and other components of a product have been tested for harmful substances. This is done by certification according to OEKO-TEX® STANDARD 100, ORGANIC COTTON or LEATHER STANDARD. Furthermore, MADE IN GREEN guarantees that these textile or leather products have been manufactured with sustainable processes under environmentally friendly and socially responsible working conditions. This is achieved by certification according to OEKO-TEX® STeP.

The OEKO-TEX® STANDARD 100 certification is a world widely consistent, independent testing and certification for raw, semi-finished, and finished textile products at all processing levels, as well as accessory materials used. Examples of articles that can be certified are raw and dyed / finished yarns, woven and knitted fabrics, accessories, such as buttons, zip fasteners, sewing threads or labels as well as ready-made articles of various types (garments of all types, domestic and household textiles, bed linen, terry products etc.).

On the basis of its comprehensive and strict catalogue of measure, the STANDARD 100 takes account of:

- important legal regulations, such as banned azo colourants, pentachlorophenol, per- and polyfluoroalkyl substances (PFAS), cadmium, lead (US-CPSIA), etc.
- numerous harmful chemicals, even if they are not yet legally regulated
- numerous also environmentally relevant sub-stance classes
- requirements of Annexes XVII and XIV of the European Chemicals Regulation REACH, US CPSIA (lead), EU POP regulation as well as of the ECHA SVHC Candidate List (insofar as they are assessed by the OEKO-TEX® Association to be relevant for the articles. Developments that are considered to be relevant are taken into account as quickly and effectively as possible through updates to the Standard)

Test criteria and limit values of the STANDARD 100 in many cases go far beyond applicable national and international standards.

The required STANDARD 100 certificates must be valid at the time of label issue.²

² Further information on STANDARD 100, ORGANIC COTTON or LEATHER STANDARD are available at www.oeko-tex.com.



The OEKO-TEX® ORGANIC COTTON certification is based on the criteria of the OEKO-TEX® STANDARD 100 and intended for any textile article made of at least 70% organic cotton. However, mixtures of conventional and organic cotton are forbidden in this certification. The ORGANIC COTTON certification offers verification from farm to product through full coverage of the chain of custody by tracking the flow of goods with transaction certificates. Products bearing this label have been manufactured without the use of GMOs and tested for pesticides and other harmful substances.

The OEKO-TEX® LEATHER STANDARD certification defines the general, technical and legal conditions for the testing and certification of leather materials, leather fibre boards, skins and furs and products manufactured with these materials on the basis of the standard and for the licensing and use of the OEKO-TEX® LEATHER STANDARD trademark. The LEATHER STANDARD is applicable, if the material is leather or rather semi-finished leather in the sense of EN 15987 or leather fibre board; and hereby for all levels of production. The standard is also valid for ready-made articles produced with these materials (e.g. leather clothing, made-up leather accessory products). The LEATHER STANDARD is also applicable for upholstery material made of leather. If the leather product (e.g. leather garment) contains also textile and non-textile (e.g. metallic) components, for these components the conditions and criteria of the latest valid STANDARD 100 are applied.

OEKO-TEX® STeP is an independent certification system for manufacturers from the textile and leather chain who want to communicate their achievements regarding sustainable production to the public in a transparent, credible and clear manner. The assessment is carried out using management systems from the areas of quality, chemicals and the environment. The aim of the STeP certification is the permanent implementation of environmentally friendly production processes, optimum work and health protection and socially acceptable working conditions. The STeP certification offers a comprehensive analysis and evaluation of sustainable production conditions. This includes supporting the production facilities in measuring and sustainably improving their environmental performance, work safety performance and social responsibility as well as in transparently making these points known to industry and consumers. The required STeP certificates must be valid at the time of label issue.³

3.2 Licensing (trademark)

The conditions for brand use (labelling) are based on the MADE IN GREEN Standard and the Terms of Use (ToU) in Annex II.

In accordance with the meaning of MADE IN GREEN, the MADE IN GREEN label is protected under trademark law. MADE IN GREEN is internationally registered as a trademark.

To strengthen trademark protection, not only the MADE IN GREEN trademark as such, but also the wordmark OEKO-TEX® (OEKOTEX, ÖKO-TEX) and various design elements such as logo and icon are protected.

The MADE IN GREEN trademark, including all OEKO-TEX® trademarks such as OEKO-TEX® STANDARD 100 and OEKO-TEX® STeP, shall only be used by those who are authorized to do so.

Prerequisites for licensing are data collection in the myOEKO-TEX® platform and the MADE IN GREEN dashboard in accordance with all requirements, fulfilment of all required MADE IN GREEN criteria and agreement with the Terms of Use (ToU) and the Institute-specific Terms and Conditions.

³ Further information about STeP is available at www.oeko-tex.com.



3.3 Trademark use

For the use of the trademark OEKO-TEX® MADE IN GREEN, the principles and illustrations set out in Annex 2 Labelling, Annex 3 Requirements for verification and use of a label by third parties, Annex 4 MADE IN GREEN Implementation examples and Annex II Terms of Use (ToU) apply. The use of the MADE IN GREEN trademark in any other way or form or the omission of individual elements is expressly prohibited.

Each MADE IN GREEN labelling must be carried out in such a way that it clearly indicates to which article the product ID used refers.

These obligations are essential. Violation of these obligations may result in the withdrawal of the permission to use the MADE IN GREEN trademark.

4. Procedure for obtaining the OEKO-TEX® MADE IN GREEN label

4.1 General conditions

The MADE IN GREEN label is only available by using the myOEKO-TEX® platform and the MADE IN GREEN dashboard.

4.2 The myOEKO-TEX® platform

The myOEKO-TEX® platform serves the customer to manage his OEKO-TEX product portfolio, customer data and Buying Guide information.

The myOEKO-TEX® platform offers a web-based management tool for products and supplier networks that enables supply chain information to be kept up-to-date. In order to access the MADE IN GREEN dashboard, the applicant must first register with an application form under www.oeko-tex.com.

The myOEKO-TEX® platform offers:

- A platform that enables tracking and managing the sustainability of the entire supply chain. It meets the process quality, efficiency, environmental and social requirements set out in the STeP Standard. This process is based on performance indicators (KPIs), which are defined in the STeP Standard, and can be documented and tracked in the section “Statistic”. The use of the section “Supplier Management” results in the creation of an overview of supply chain networks connecting companies with their suppliers.
- Tools with the possibility to carry out targeted comparisons and analyses of suppliers within a network on the basis of the following factors: score of STeP certified companies, performance indicators and sustainability factors. The transparent display of key performance indicators serves as a benchmark that not only facilitates the comparison of suppliers, but also helps to identify and eliminate potential risks in the existing supply chain. The resulting visualization helps to select new suppliers or improve the performance of existing suppliers.
- A database that enables benchmarking and statistical analysis of the supply chain as well as transparent management of existing OEKO-TEX® certificates (STANDARD 100, ORGANIC COTTON, LEATHER STANDARD, STeP) including validity checks.

The myOEKO-TEX® platform can be used by all interested companies in the textile or leather industry, regardless of whether they are an OEKO-TEX® customer or not. Further information on the myOEKO-TEX® platform and the MADE IN GREEN dashboard are available at www.oeko-tex.com or by contacting one of the OEKO-TEX® Institutes (Annex 1).



MADE IN GREEN

4.3 The MADE IN GREEN Process

The procedure for applying for a MADE IN GREEN label is described in the illustration below.

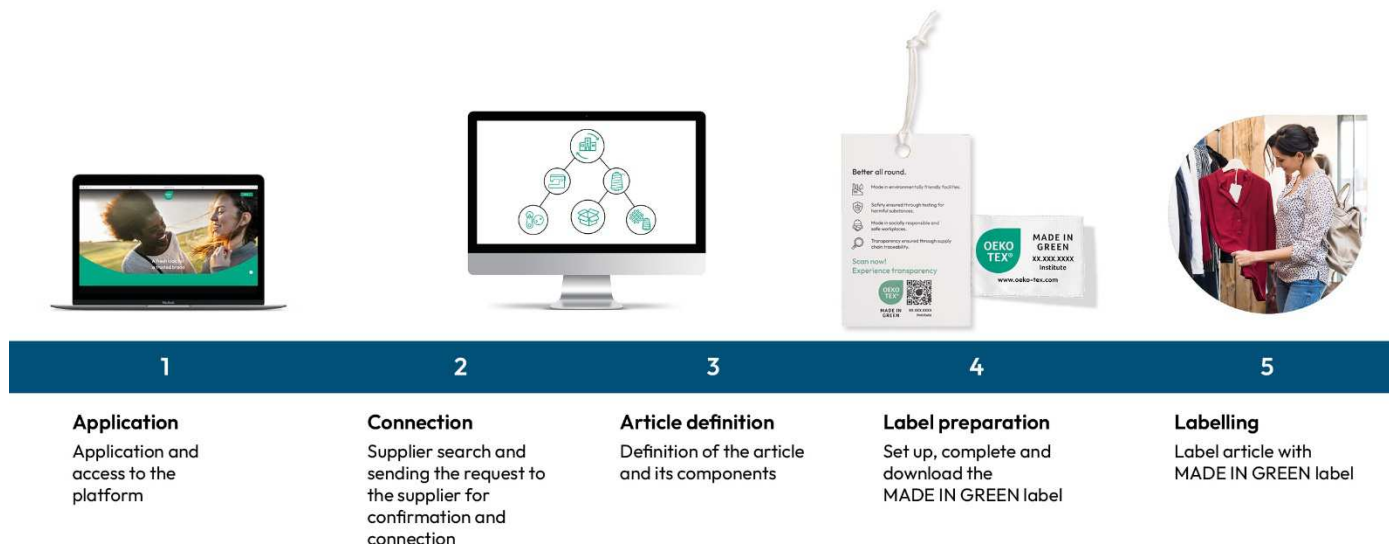

4.3.1 Application

To get access to the myOEKO-TEX® platform and the MADE IN GREEN dashboard the customer shall first fill in the application form on www.oeko-tex.com. With the submission of the application form for MADE IN GREEN alongside the signed ToU, the applicant accepts that administration costs can be charged from the supervising institute, if too much time is required for customer support. The use of the myOEKO-TEX® platform and the MADE IN GREEN dashboard as well as the label issue are free of charge.

4.3.2 Connection

In order to create a MADE IN GREEN label (product ID), the applicant needs information about their supply chains. The applicant contacts the relevant production facilities / suppliers via the myOEKO-TEX® platform in the section “Supplier Management” and requests the release of their data. The requested facilities / suppliers determine if and which data the applicant or other users of the myOEKO-TEX® platform can see.

The applicant finds the essential suppliers for their application by entering supplier’s certificate number (STANDARD 100, ORGANIC COTTON, LEATHER STANDARD or STeP) or the company name and address. This allows the invitation of suppliers into their supply chain. The relevant supplier can confirm the invitation.

By confirming the request, the supplier can decide which data to make accessible to their customers on the myOEKO-TEX® platform and the MADE IN GREEN dashboard. There are three permission levels from which the supplier selects one. By selecting the permission level, the corresponding data is automatically displayed in the MADE IN GREEN dashboard and on the website.

The label owner has access to the information of the suppliers at least with permission level 1.



MADE IN GREEN



Permission Level 1

Suppliers remain anonymous



Permission Level 2

Publication of supplier data (including the supply chain of the supplier)

- Company name
- Address
- STeP Scoring



Permission Level 3

Publication of supplier data (including the supply chain of the supplier)

- Company name
- Address
- STeP Scoring
- Audit Report

Permission 1

B2B Website:
Display country, certifications and type of operations

B2C Website (End Customer):
Display country of the facility and type of operation

Permission 2

B2B Website:
Display company name, certifications, type of operations and OEKO-TEX® STeP scoring data - total and modular

B2C Website (End Customer):
Display country, name and address of the facility, as well as type of operation

Permission 3

B2B Website:
Display company name, certifications, type of operations and OEKO-TEX® STeP scoring data - total and modular and access to the last STeP audit report (certification report positive or negative)

B2C Website (End Customer):
Display country, name and address of the facility, as well as type of operation

Data release B2B:

The permission level specified in the myOEKO-TEX® platform is displayed in the MADE IN GREEN dashboard as follows:

- Permission Level 1: Country, STANDARD 100, ORGANIC COTTON, LEATHER STANDARD and STeP certifications and types of operation are displayed.
- Permission Level 2: Country, company name, address, types of operation, STANDARD 100, ORGANIC COTTON, LEATHER STANDARD and STeP certifications, STeP results (total and modular) are displayed.
- Permission level 3: Country, company name, address, types of operation, STANDARD 100, ORGANIC COTTON, LEATHER STANDARD and STeP certifications, STeP results (total and modular), STeP audit report are displayed.

Data release B2C:

The permission level specified in the myOEKO-TEX® platform is displayed as follows in the label check on www.oeko-tex.com when the linked MADE IN GREEN label is queried there:

- Permission level 1: Country and types of operation as icons are displayed.
- Permission level 2: Country, company name, address and types of operation as icons are displayed.
- Permission level 3: Country, company name, address and types of operation as icons are displayed.

4.3.3 Article definition

The article definition contains the identification of the product, the respective component and the process stages within



the corresponding supply chain. This is the basis for the creation of the MADE IN GREEN product ID.

The applicant enters the following article information in English (translations can be added):

- Article name: shall consist only of the product name and the type of product (e.g. the product brand name). If two or more articles with the same product category and function are to be sold as a set, the article name shall contain information about the article set.
 - Example 1: [Brand] Polo Shirts
 - Example 2: [Brand] Leather Pencil Skirt
 - Example 3: [Brand] Girls Pyjama Set
- Article number: shall be specified for further identification (e.g., the product style number)
- Article description: shall include information about materials in the product, including at minimum, the fibre content of main components. The article description shall contain any other important product description (e.g. dyeing, finishing and / or printing processes). For article sets, the description shall contain information about all product types in the set. The information from the 'Article name' field shall not be repeated. The article description should be phrased as a sentence.
 - Example 1: Modern fit polo shirt for men made of 100% cotton jersey fabric.
 - Example 2: Leather skirt made of 100% suede leather produced from lambskin.
 - Example 3: Pyjama set includes a long sleeve top and a trouser in polyester/elastane, fabric disperse dyed, printed all over.
 - Example 4: T-shirt made of knitted fabric in 100% cotton and mixtures with polyester, viscose, and elastane, yarn-dyed and pigment printed.
- Categories (e.g. finished or semi-finished product)
- Selection of the appropriate STANDARD 100, ORGANIC COTTON or LEATHER STANDARD certificate
- Dyed or raw/greige article (selection of specific article colours is possible)

4.3.3.1 Article

An article is a textile or leather product that can be labelled with the MADE IN GREEN label.

4.3.3.2 Requirements for MADE IN GREEN product ID

The MADE IN GREEN product ID is generated in the MADE IN GREEN dashboard for each item with its specific supply chain. Each MADE IN GREEN label issued thus has an individual product ID.

When the product ID is entered in the [OEKO-TEX® Label Check](#), the following product information can be displayed. These details must be pre-defined in the MADE IN GREEN dashboard.

- Label validity and traceability: A confirmation that this product has been produced according to the MADE IN GREEN requirements.
- Article supply chain: The location and types of producers involved in the MADE IN GREEN supply chain on the world map. Depending on the selected permission level (1-3), further information is available (e.g., address of production facilities).
- Article name and description:
 - The term "recycled" shall only be used in the article name and / or description of a MADE IN GREEN labelled product, if the article is covered in the related STANDARD 100 Recycled Materials certificate
 - The term "organic" shall only be used in the article name and / or description of a MADE IN GREEN labelled product, if the article is covered in the related OEKO-TEX® ORGANIC COTTON certificate.
- Article number(s)
- Article colour(s)
- Product image: The product image is intended to serve as an example of the product and convey more product transparency to end consumers. The product image should be a professional photo representative of the product labelled with MADE IN GREEN, i.e., product image without packaging material, foil, wrapping paper, cardboard, and plastic bag. The product image can represent all available product colours in one article group.



The product can be traced back to the countries of manufacture. All main manufacturing processes of the MADE IN GREEN supply chain should be displayed according to the criteria in Chapter 2 Applicability OEKO-TEX® MADE IN GREEN. The MADE IN GREEN aim is a 100% traceable supply chain for all involved product specific manufacturing processes from raw material inputs to factory gate of the finished or semi-finished product.

If the product is made from recycled materials, all suppliers who source/ buy/ process these recycled materials should be included in the MADE IN GREEN label supply chain to ensure transparency and a complete supply chain map on the www.oeko-tex.com Label Check.

Wet/ chemical processes of main product components that take place after recycling shall be OEKO-TEX® STeP certified (e.g., fabric/ garment dyeing/ finishing, washing). The product made of recycled materials shall be OEKO-TEX® STANDARD 100 certified.

4.3.3.3 Specifications for MADE IN GREEN components

Components include all individual parts of the article to be marked with the MADE IN GREEN label. Only one specific producer can be defined for each component. The applicant enters the component information in English (translations can be added).

Component requests shall be confirmed by the relevant producers. Single components that equal or exceed 5% of the total weight of the product shall be supplied by OEKO-TEX® STeP certified production facilities. This concerns only facilities with wet / chemical processes. Metal and plastic accessories, as well as rubber and cardboard are not considered.

- A main component is a single component that equals or exceeds 5% of the total weight of the MADE IN GREEN article.
- A small component is a single component that weighs less than 5% of the total weight of the MADE IN GREEN article.

Main article components with different material composition (fibre blend):

All wet spinning facilities should be included in the MADE IN GREEN supply chain and certified according to OEKO-TEX® STeP. This applies to all material compositions of a main article component, regardless of their fibre blend.

- Example a) T-Shirt – main component: Knitted fabric made of 98% cotton (mechanically spun), 2% viscose (wet/chemically spun), in grey mélange.
 - STeP certification for wet spinning processes is recommended, i.e., viscose fibre manufacturing, and should be included in the MADE IN GREEN supply chain.
- Example b) Bermuda shorts – main component: Knitted fabric made of 50% cotton (mechanically spun), 45% lyocell (wet/chemically spun), 5% elastane (thermally spun).
 - STeP certification for wet spinning processes is recommended, i.e., lyocell fibre manufacturing, and should be included in the MADE IN GREEN supply chain.

Main article components with different dyeing technologies:

All dyeing facilities shall be included in the MADE IN GREEN supply chain and certified according to OEKO-TEX® STeP (excluding thermal spun dyeing processes). This applies to all material compositions of a main article component, regardless of their fibre blend.

- Example a) Work dungarees – main components: Woven fabric (piece dyed) made of 65% recycled polyester, 35% cotton. Shoulder straps made of 100% polyester (thermally spun-dyed).
 - STeP certification for wet dyeing processes is required, i.e., piece dyeing, and shall be included in the MADE IN GREEN supply chain.
- Example b) T-Shirt – main component: Knitted fabric made of 98% cotton (yarn-bleached), 2% viscose (wet/chemically spun dyed), in grey mélange.



MADE IN
GREEN

- STeP certification for wet dyeing processes is required, i.e., cotton yarn bleaching, and shall be included in the MADE IN GREEN supply chain.
- STeP certification for wet/chemical spun dyeing process is recommended, i.e., viscose fibre spun dyeing, and should be included in the MADE IN GREEN supply chain.
- Example c) Boxer briefs – main components: Knitted fabric (piece dyed) made of 95% cotton, 5% elastane. Elastic waistband made in 60% polyester (yarn-dyed), 30% polyamide (yarn-dyed), 10% elastane (thermally spun-dyed).
 - STeP certification for wet dyeing processes required, i.e., piece dyeing, polyester and polyamide yarn dyeing, and shall be included in the MADE IN GREEN supply chain.

Product examples of how MADE IN GREEN can be implemented are visualised in Annex 4 [MADE IN GREEN Implementation Examples](#).

4.3.3.4 Specifications for MADE IN GREEN article groups

Under certain exceptional circumstances, an article group or product line can be summarized in one product ID. However, the following requirements shall be met so that transparency of individual production steps for all involved parts of the article group are properly provided:

- The entire article group must share the same supply chain and identical production processes. This ensures the transparency of individual production steps is provided and the environmental impact of the article group can be clearly determined.
- The following examples are not considered to have identical production processes for MADE IN GREEN and cannot be combined into one product ID, even if they come from the same supply chain:
 - article group dyed with different dyeing technologies (e.g., fibre, yarn, piece, garment dyeing),
 - article group printed with different printing technologies (e.g., motif, all-over, inkjet printing),
 - article group dyed all in one colour with no printing versus printed article group,
 - woven versus knitted article group,
 - etc.
- The same number of components must be involved (the proportion of components by weight is comparable in the entire article group or product line),
- Identical product category and function (e.g., protective jacket versus casual trousers),
- The entire article group or product line is covered under one STANDARD 100, ORGANIC COTTON or LEATHER STANDARD certificate,
- The manufacturing process for the article group or product line must be certified according to STeP.

Application examples:

- a) T-shirt in 20 colours + produced within one supply chain = 1 product ID
- b) T-shirt in 20 colours + produced in three supply chains = 3 product IDs
- c) Pullover and T-shirt + produced in one supply chain = 2 product IDs (1 ID for pullover and 1 ID for T-shirt)

4.3.3.5 Criteria: OEKO-TEX® STANDARD 100, ORGANIC COTTON or LEATHER STANDARD Certification

Every product for which a MADE IN GREEN label is to be issued must have a valid STANDARD 100, ORGANIC COTTON or LEATHER STANDARD certificate corresponding to the article. Combined certificates are not permitted.

4.3.3.6 Criteria: OEKO-TEX® STeP Certification

Each product for which a label is to be issued must have one or more valid STeP certificate(s). The MADE IN GREEN requirements and criteria for which a valid STeP certificate is required can be found in Chapter 2 Applicability of OEKO-TEX® MADE IN GREEN in this standard. The following are application examples for the necessity of STeP certification for wet / chemical processes (see Chapter 2 Applicability OEKO-TEX® MADE IN GREEN Criteria 3):

- Since the weight of individual components can vary when weighing – due to the deviations known in textile or



leather processes - a tolerance of +/- 0.5% can be normal and must be taken into account when applying the criteria.

- Textile or leather garments are usually produced in a range of sizes. For the calculation and fulfilment of the STeP criteria, the median size of the size range shall be taken into account.
 - Example a) A polo shirt is produced in sizes XS, S, M, L and XL. In this case, the polo shirt size M must be used for the calculation.
 - Example b) A jacket is produced in sizes S, M, L and XL. In this case, the jacket size M must be used for the calculation.
 - Example c) For baby pyjamas of 0-12 months, the reference size for calculating the STeP criteria shall be 6 months.
 - Example d) For children's trousers from 1-14 years, the reference size for calculating the STeP criteria is 7 years.

4.3.4 Label preparation

If the conditions of the MADE IN GREEN Standard are met for the product or product line and the applicant has accepted the Terms of Use (ToU), the applicant will be automatically authorized in the MADE IN GREEN Dashboard to issue a MADE IN GREEN label for the specific product or product line. During the MADE IN GREEN label setup, a professional product image of the article should be uploaded to appear publicly for buyers and consumers in the "Label Check" section of www.oeko-tex.com. After the label preparation has been successfully completed, a product ID for the relevant product is generated automatically and the applicant of the MADE IN GREEN label can download the label artwork in the MADE IN GREEN Dashboard. This entitles the applicant to use the MADE IN GREEN label for 1 year.

4.3.5 Labelling

The MADE IN GREEN label is regulated in Annex 2 Labelling.

5. Basis of legal relationship

5.1 Basis of OEKO-TEX® MADE IN GREEN

The legal relationship between the customer and OEKO-TEX® is based on an application by the customer to an OEKO-TEX® approved institute of his choice (Annex 1 OEKO-TEX® Institutes). All kinds of textile and leather products defined in the customer's application must be licensed in accordance with this standard document.

In addition, the Terms of Use (ToU) in accordance with Annex II Terms of Use (ToU) valid for all OEKO-TEX® products apply. The Terms of Use can be viewed at www.oeko-tex.com/ToU.

5.2 Use of the trademark OEKO-TEX® MADE IN GREEN

With the release to issue the MADE IN GREEN label, OEKO-TEX® grants the customer the right to use the trademark OEKO-TEX® MADE IN GREEN in accordance with the ToU and this standard.

The correct use of the label is described in detail in Annex 2 Labelling and Annex 3 Requirements for verification and use of a label by third parties.

The owner of the label is only allowed to use the label in the form published by OEKO-TEX®. In the MADE IN GREEN dashboard, the label holder has direct access to the various designs of the MADE IN GREEN label.

If the trademark OEKO-TEX® MADE IN GREEN is used in contravention of the regulations for use, the ToU shall apply in accordance with Sections 7.5 Withdrawal and misuse of certificates, licenses and 11 Regulations for the use of the



OEKO-TEX® Marks.

5.3 OEKO-TEX® Quality Assurance

The Terms of Use in accordance with Section 13 OEKO-TEX® Quality Assurance shall apply. The quality of each MADE IN GREEN label is assured by an internal validation process. The customer also accepts that the labelled articles will be monitored and controlled by OEKO-TEX® and / or the OEKO-TEX® approved institutes for the purposes of OEKO-TEX® quality assurance.

5.4 Usage of the MADE IN GREEN label

5.4.1 Validity

The MADE IN GREEN label can be used for product labelling only once its status is valid in the MADE IN GREEN dashboard. A MADE IN GREEN label with pending status is not valid and therefore cannot be used for product labelling.

On the date of a MADE IN GREEN label issue or renewal, all certificates underlying the MADE IN GREEN Standard shall be valid. The MADE IN GREEN label shall always be valid as long as the MADE IN GREEN labelled product is currently being manufactured.

The MADE IN GREEN label is valid for one year. Subsequently, the annual renewal for the existing product ID can be applied for within one year of the expiration date. The MADE IN GREEN label owner ensures that the certificates on which his MADE IN GREEN label is based are valid. Component confirmation(s) shall be renewed every year by the relevant producers. If the MADE IN GREEN labelled product is no longer being manufactured and there is only remaining inventory in the warehouse, renewal of the MADE IN GREEN label is not required.

For 5 years after validity expires, end users can trace the product ID via the [OEKO-TEX® Label Check](#). This works for any products manufactured during the MADE IN GREEN label validity period.

All major changes to the product and/ or within the supply chain mean that a new product ID must be created.

5.4.2 Misuse and Withdrawal of license

The Terms of Use (ToU) shall apply in accordance with Section 7.5 Withdrawal and misuse of certificates, licenses and Section 11 Regulations for the use of the OEKO-TEX® Marks. If the internal validation process shows that the MADE IN GREEN label does not meet the requirements (see chapter 5.3), recommendations and obligations can be given. If obligations are not met within the specified timeframe, the MADE IN GREEN label can be withdrawn.

Withdrawal of the relevant OEKO-TEX® certificates in the MADE IN GREEN label supply chain can lead to withdrawal of the MADE IN GREEN label if the MADE IN GREEN criteria and requirements are no longer met. Detailed information on re-certification will be provided by the supporting institute.

To prevent misuse of the rules listed in the MADE IN GREEN Standard, access to the MADE IN GREEN Dashboard can be revoked if the customer fails to meet the MADE IN GREEN requirements and criteria to issue a MADE IN GREEN label in an orderly manner.



Annex 1

OEKO-TEX® Institutes

The International OEKO-TEX® Association consists of independent institutes in Europe and Japan, with offices around the globe.

The testing and research institutes offering certification and licensing according to MADE IN GREEN, STANDARD 100, ORGANIC COTTON, LEATHER STANDARD, STeP, ECO PASSPORT and / or RESPONSIBLE BUSINESS can be found on the OEKO-TEX® homepage www.oeko-tex.com/en/about-us/offices.

The OEKO-TEX® Secretariat can be contacted at the following address:

OEKO-TEX Service GmbH
Genferstrasse 23, CH-8002 Zürich, Switzerland
Phone: +41 44 501 26 00
E-Mail: info@oekotex.com
Web: www.oeko-tex.com

Annex 2

Labelling

When an OEKO-TEX® MADE IN GREEN label is issued, the label holder receives a licence to use the corresponding OEKO-TEX® label.

The OEKO-TEX® Labelling Guide covers rules and guidelines that govern the use of the OEKO-TEX® trademark and OEKO-TEX® labels. It defines the guideline for a standardised appearance of the OEKO-TEX® labels. It assists companies, manufacturers, brands, retailer and all OEKO-TEX® partner to label their certified products correctly and to develop marketing materials to communicate company efforts.

[Labelling Guide](#)

All layout version of the OEKO-TEX® labels can be downloaded via the Label Editor in the myOEKO-TEX® platform.

Annex 3

Requirements for verification and use of a label by third parties

3.1 Use of the MADE IN GREEN label by third parties

There are three rules for brands and retailers who wish to use their supplier's MADE IN GREEN label in their marketing materials (on product-hangtags, packaging, sewn-in labels, brochures, catalogues and on the website):

1. The MADE IN GREEN label may be used by third parties free of charge, but only with the permission of the label owner.
2. The MADE IN GREEN label must have a clear reference to the labelled product and may never be used without the direct product references.
3. The core elements of the MADE IN GREEN label listed in Annex 2, Chapter 2.1 must be fulfilled.



MADE IN GREEN

3.2 Relabelling of an existing product ID by a third party

Brands and retailers can re-label their supplier's MADE IN GREEN number under their own company name, but only by complying with all subsequent requirements:

1. The existing product ID can be re-labelled by third parties with confirmation of the product by the label owner and using the MADE IN GREEN dashboard.
2. The existing product ID is valid at the time of re-labelling.
3. The MADE IN GREEN label must also have a clear reference to the labelled product and must never be used without the direct product references.
4. The core elements of the MADE IN GREEN label shall be fulfilled (Annex 2 Labelling).

3.3 Use of the MADE IN GREEN advertisement label by third parties

Retailers who sell MADE IN GREEN labelled products can receive their own MADE IN GREEN advertisement label by complying with all subsequent requirements:

1. Retailer submits MADE IN GREEN application
2. Retailer connects with each of their suppliers with at least one valid MADE IN GREEN product ID via myOEKO-TEX® platform 'Supplier Management' section (4.3.2 Connection).
3. Each product is clearly labelled with the specific MADE IN GREEN label/product ID.
4. The core elements of the MADE IN GREEN advertisement label shall be fulfilled (Annex 2 Labelling).

This MADE IN GREEN advertisement label can only be used in general marketing materials (i.e., brochures, catalogues, exhibition banners), to represent all valid MADE IN GREEN product IDs/label numbers under one uniform label number.

Annex 4

MADE IN GREEN implementation examples

4.1 Examples of the implementation of the MADE IN GREEN criteria

	STANDARD 100	OR	ORGANIC COTTON	OR	LEATHER STANDARD	
	The product shall be OEKO-TEX® STANDARD 100 or OEKO-TEX® ORGANIC COTTON or OEKO-TEX® LEATHER STANDARD certified					
	STeP					The making up facility shall be OEKO-TEX® STeP certified
1	STeP					70% of the total weight, main material: Wet finishing facility shall be OEKO-TEX® STeP certified
2	STeP					15% of the total weight, additional material: Wet finishing facility shall be OEKO-TEX® STeP certified
3	STeP					8% of the normal weight, additional material: Wet finishing facility shall be OEKO-TEX® STeP certified
4						4% of the normal weight: Metal and plastic accessories are not considered
5						3% of the total weight, sewing thread: OEKO-TEX® STeP not necessary

Implementation Examples of the MADE IN GREEN criteria in relation to STeP certifications can be found [here](#).



MADE IN
GREEN

Annex 5

Terms and definitions

All terms and definitions according to STeP, STANDARD 100, ORGANIC COTTON and LEATHER STANDARD are valid for this document. A list of additional terms can be found on the OEKO-TEX® website.

5.1 Additional Terms

See [glossary](#) on OEKO-TEX® website.

5.2 Types of Operation

[Click here](#) for detailed explanations.

5.3 Type of Dashboard Users

[Click here](#) for detailed explanations.



MADE IN GREEN

I Annex

Declaration of Conformity

See Declaration of Conformity in STANDARD 100, ORGANIC COTTON or LEATHER STANDARD (www.oeko-tex.com).

II Annex

Terms of Use & Code of Conduct

The OEKO-TEX® Terms of Use (ToU) apply for all OEKO-TEX® products. The ToU can be found under www.oeko-tex.com/ToU. The OEKO-TEX® CoC can be found under www.oeko-tex.com/CoC.

Please use the form below to confirm the OEKO-TEX® Terms of Use and send it to the responsible OEKO-TEX® Institute.

Online

By checking the box, you confirm that you are legally entitled and have signatory power to represent the user and that you have read, understood and agree fully with these Terms.

Agreed and accepted by user (Hardcopy form)

By putting its signature at the signature block below, the User confirms that it has read, understood and agrees fully with all the terms and conditions contained herein, including its annexes.

Name of Company	
Legal entity (form)	
Registered office address	
Legal venue (country)	
Responsible person	
Phone	
Fax	
Email	
Homepage	

These Terms must be signed by two authorised representatives of the user, with signatory power, one of which is a member of its board and the other of which is preferably the individual within the user's organization who is responsible for the myOEKO-TEX® platform and MADE IN GREEN dashboard.



MADE IN
GREEN

Signature 1	<hr/> <hr/>
Name	<hr/>
Title	<hr/>
Date, Place	<hr/>
Signature 2	<hr/> <hr/>
Name	<hr/>
Title	<hr/>
Date, Place	<hr/>